

# ARCHITECTURE PORTFOLIO

Selected projects 2012-2019  
Eelco Wind

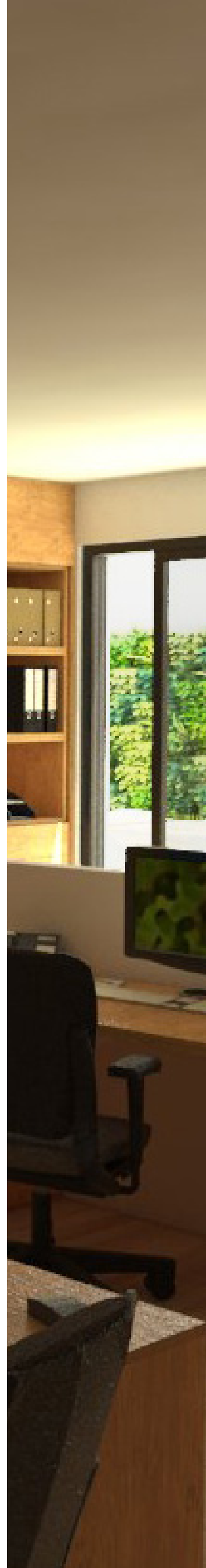

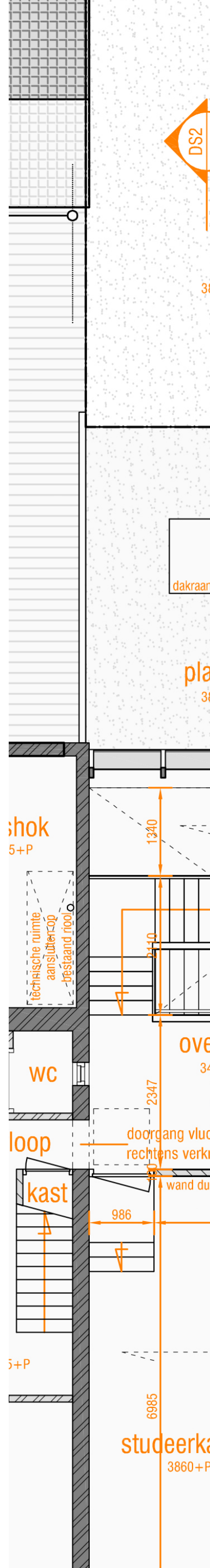



## DISCLAIMER

This portfolio has its aim to showcase selected projects by Eelco Wind from his academic and professional work from 2012 until today. The copyrights of academic projects are shared property of the student and the educational institution, while the copyrights of the professional projects belong to the architecture firm of employment.

For the content of this portfolio the following software has been used:

Autodesk AutoCAD  
Autodesk Revit  
Adobe Indesign  
Adobe Photoshop  
Sketchup Modeler  
Sketchup V-Ray



Office renovations aim not only to accomplish innovation and functionality, but ultimately strive to improve the performance, behaviour, and overall well-being and health of those working there. This office originally dates from 1995 and has an interior area of 100m<sup>2</sup> and a terrace area of 57m<sup>2</sup>. Since the day of its construction, the office has not been through any process of renovation or modernization.

Our vision for the renovation is to apply Industrial Ecology concepts to an integrated, holistic design. The concept is based on a systems thinking approach, which combines management tools, operational needs and a sustainable design that encourage the organization to be sustainable and encourage the employees to behave more ecologically friendly.

The design approach integrates a total of two merits, as visualized in **Diagram 1** below. The holistic design aims to find **Integrated solutions to social, environmental and technical needs** with a circular, closed-loop design that ambitions to achieve synergies between six main technical clusters: Energy, Water, Agriculture, Waste, Circular Economy and Transport. Each of these clusters is a source of inspiration for the design and a source for improvement of environmental and human well-being. The last merit, **Integration of aesthetic and functional aspects**, is embedded and it is intrinsic to the office renovation design.

**Energy:**

- Maximization of the use of natural light by creating an open floor plan
- Solar Panels as a source of renewable energy system
- Low consumption appliances, LED lights, Micro-moving sensors

**Water:**

- Water-saving appliances: Dual flush toilets, greywater reuse
- Rainwater harvesting and water recirculation

**Agriculture:**

- Based on a vertical aquaponic system design
- Ecological food production with a diversity of crops
- Promote local production and consumption for our employees

**Waste:**

- Waste separation: Carton and paper; plastic and metals; organic; special waste
- Implementation of vermicomposting for fertilizer production



EUCO OFFICE

BOGOTÁ, CO

2016

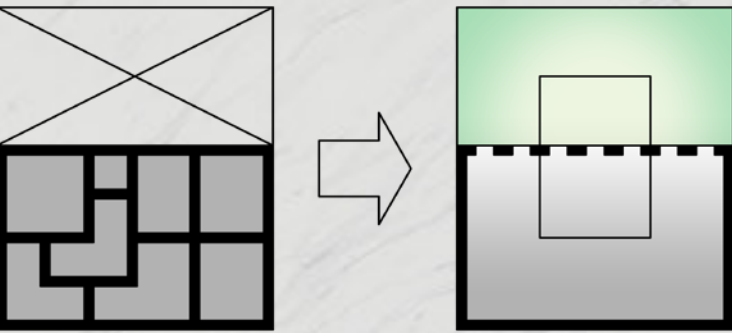

Transform cells to open space and incorporate the garden



**EUCO OFFICE**

**BOGOTÁ, CO**

**2016**

